

BED FRAME INSTRUCTIONS FOR MODEL B100-66

Queen, King, California King

OVERVIEW OF FRAME PARTS:

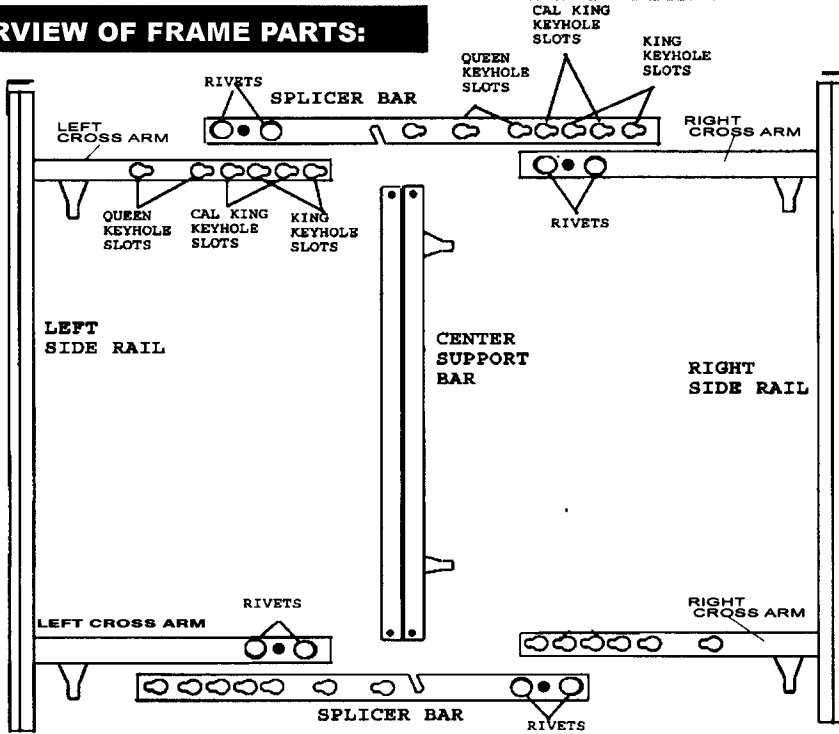

STEP 1

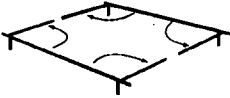

Unfold end rails from under side rail and lay all parts out as shown in overview of frame parts.

STEP 2

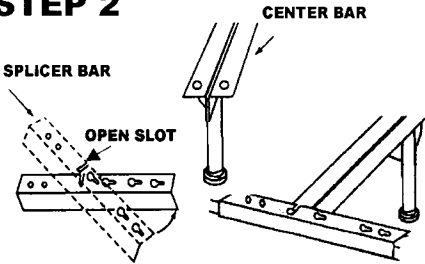

Connect splicer bar to center support by inserting the rivet at the end of the center support bar into the center keyhole slot of the splicer bar, then slipping the open slot on the splicer bar under the rivets on the center bar and swing into place.

STEP 3

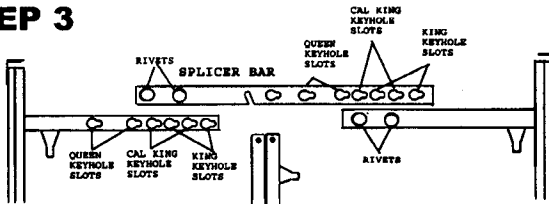

Attach splicer bars to siderails by selecting proper set of keyhole slots for size of bedding and lock together using steps 4,5 and 6.

STEP 4

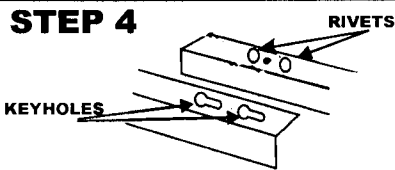

Connect cross arms to splicer bars by placing rivets into keyholes.

STEP 5

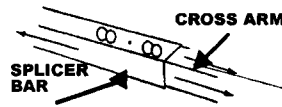

Pull cross arms outward so that rivets lock in place.

STEP 6

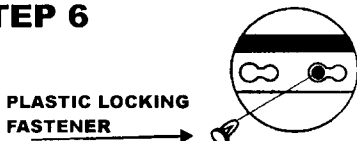

Insert plastic locking fastener through keyhole into hole in between rivets to lock cross arms into place.

STEP 7



Insert sockets and glides into all legs.

STEP 8

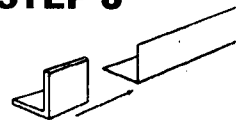

Slip plastic caps over end of side rails.